

HYATT REGENCY LONDON - THE CHURCHILL

30 Portman Square
London W1H 7BH
United Kingdom

T: +44 (0)20 7486 5800
F: +44 (0)20 7486 1255
E: london.churchill@hyatt.com
hyattregencylondon.com
@HyattChurchill



ACCOMMODATION

- 440 well-appointed guestrooms, including 50 suites, 273 king and 90 twin rooms, most of which are furnished in a quintessentially British style
- Premium suites include the Premium Balcony Suites and the newly refurbished Churchill Residential Suite
- Dedicated family rooms and suites
- The hotel is accredited with GBAC and is AA COVID Confident

All Accommodations Offer:

- Complimentary high-speed Wi-Fi
- Refurbished rooms boast advanced technology including multi-socket outlets and Japanese TOTO toilets
- 40-inch flat-panel LED Television with a wide range of international channels
- STAYCAST technology allows guests to stream from their own device
- Complimentary water
- Tea and coffee making facilities
- Dual-line telephone with separate voicemail
- Shower, bath amenities and hair dryer
- In-room safety deposit box
- Iron and ironing board
- Individual climate control
- Two Regency Club™ lounges for all-day dining, private concierge and check-in/out

RECREATIONAL FACILITIES

- The Churchill Fitness Suite (open 24 hours)
- Outdoor floodlit tennis court, jogging track and playground in the private Portman Square Garden opposite the hotel
- Dedicated treatment rooms for individual and couple treatments and massage

LOCATION

One of the finest hotels in London, Hyatt Regency London - The Churchill enjoys a prime location in Central London's West End, close to exclusive shopping and the City. Its positioning in the chic Marylebone area, adjacent to Park Lane, ensures that it is one of the best situated 5 star hotels in London from which to explore Hyde Park, Marble Arch and Buckingham Palace, some of London's most celebrated landmarks. The hotel is just two minutes from the nearest tube station, Marble Arch and the exclusive shopping areas of Oxford Street, Soho or Bond Street.

DIRECTIONS FOR TRAVELLERS

Accessible from London's major airports and within 10 to 20 minutes from several of London's main train stations. Situated 15 minutes from Paddington, where the Heathrow Express connects to Heathrow Airport in just 15 minutes.

POINTS OF INTEREST

Big Ben, British Museum, Buckingham Palace, Churchill War Rooms, Houses of Parliament, Hyde Park, London Eye, Madame Tussaud's, National Gallery, St. Paul's Cathedral, Tate Modern Gallery, Theatres, Tower of London, Wallace Collection, West End Shopping

VISITOR INFORMATION

- Language: English
- Currency: British Pound (GBP)
- Voltage: 240 volts
- Climate: London has a pleasant climate with warm summers and mild winters. The average temperatures vary from 5°C / 41°F in Winter to 20°C / 68°F in Summer
- Visas: Contact the British Consulate

SERVICES & FACILITIES

- Multilingual staff and concierge service
- 24 hour Business Centre in Lobby
- 24 hour Room Service
- Concierge & Co. hotel souvenir shop
- Access to newspaper and magazines online
- Babysitting and crib upon request
- Dry cleaning and laundry
- Private transfers available

RESTAURANTS & BARS

- The Montagu Kitchen — An all-day dining restaurant to relax and indulge in a wide range of British seasonal dishes, all of which are prepared in a striking open kitchen. Also famed for Afternoon Tea, Sunday Brunch, and the Chef's Table
- The Churchill Bar & Terrace — An award-winning bar and terrace with a notable menu of creative craft cocktails designed by expert mixologists, premium spirits and cigars. Offers a year-round heated terrace and its own entrance from Portman Square
- Locanda Locatelli — Award-winning Michelin star fine dining restaurant with authentic Italian cuisine

MEETING & EVENT SPACE

- 770 sq m / 8,288 sq ft of flexible event space accommodating between 8-350 guests
- 12 meeting and event rooms, including a ballroom & 7 newly-refurbished modern event spaces boasting the latest technology and natural daylight
- Four interconnecting meeting and event rooms
- Four Event Rooms with natural daylight
- Wedding licence
- Access to picturesque Portman Square Garden for events up to 450 pax

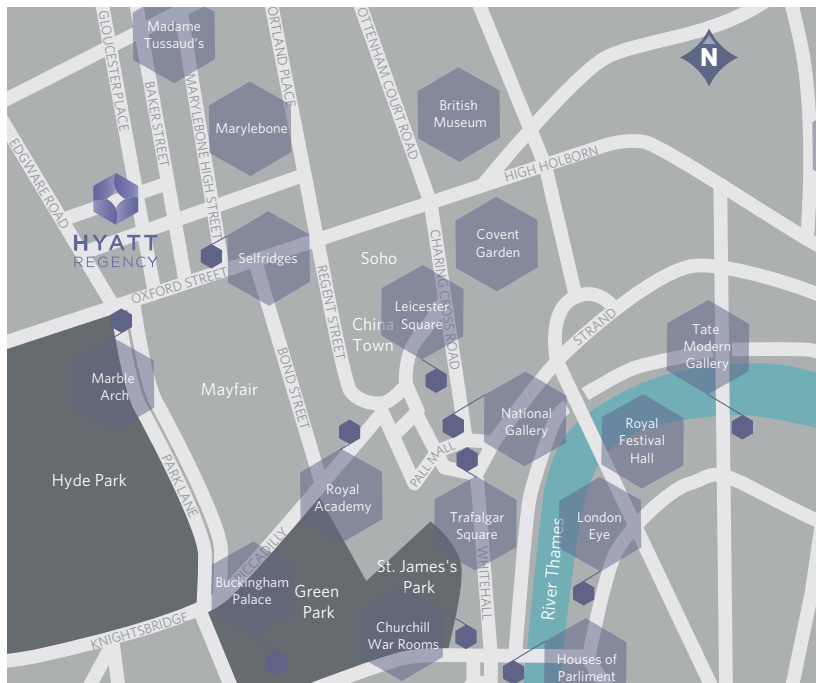

HYATT REGENCY LONDON - THE CHURCHILL

30 Portman Square

London W1H 7BH

United Kingdom

T: +44 (0)20 7486 5800

F: +44 (0)20 7486 1255

E: london.churchill@hyatt.com

hyattregencylondon.com

@HyattChurchill



CAPACITY CHART



Room Name	Room Dimensions L x W x H	Room Size Sq. M. / Sq. Ft.	Banquet	Reception	Theatre	Cabaret	Classroom	Boardroom	U-Shape	Hollow Square
Ground Floor										
CHARTWELL BALLROOM	17.3m x 14m x 3.6m 57' x 46' x 11.8'	242.2 2,662	240	350	260	144	180	50	68	85
Chartwell I	10.2m x 14m x 3.6m 33.5' x 46' x 11.8'	142.8 1,541	144	200	140	80	90	36	42	56
Chartwell II	7.1m x 14m x 3.6m 23.3' x 46' x 11.8'	99.4 1,072	96	100	100	60	63	36	38	42
THE GALLERY	8.9m x 17.2m x 2.5m 29.2' x 56.4' x 8.2'	145.4 1,565	96	132	120	64	120	45	50	60
THE GALLERY + STUDIO SUITE	31.1m x 17.2m x 2.3m 102' x 56' x 7.5'	254.2 2,736	136	252	-	-	-	-	-	-
STUDIO SUITE	22.2m x 4.9m x 2.3m 72.8' x 16.05' x 7.5'	116.4 1,253	100	120	80	-	-	-	-	-
Studio Suite I	7.1m x 4.9m x 2.3m 23.3' x 16.05' x 7.5'	34.8 374	30	35	32	21	20	18	18	18
Studio Suite II	7.1m x 6.0m x 2.3m 23.3' x 19.7' x 7.5'	42.6 459	40	45	40	32	28	20	20	18
Studio Suite III	8.0m x 4.9m x 2.3m 26.2' x 16' x 7.5'	39 419	30	40	36	24	24	20	20	18
THE LIBRARY	9m x 6.9m x 3.4m 29.5' x 22.6' x 11.2	62.1 667	50	75	60	32	40	26	28	32
BOARDROOM I	6.7m x 3.5m x 2.1m 22' x 11.5' x 6.9'	23.5 253	-	-	-	-	-	8	-	-
BOARDROOM II	4.75m x 3.5m x 2.3m 15.6' x 11.5' x 7.5'	16.6 179	-	-	-	-	-	8	-	-
Second Floor										
MARLBOROUGH SUITE	11.7m x 5.6m x 2.4m 38.4' x 18.4' x 7.9'	65.5 706	60	80	60	40	42	30	27	35
BLENHEIM SUITE	7.7m x 7.4m x 2.4m 25.3' x 24.3' x 7.9'	57 615	50	60	50	32	36	20	20	32
SPENCER SUITE	6.7m x 7.2m x 2.3m 21.3' x 23.6' x 7.5'	48.7 503	50	55	50	40	24	30	21	24

HYATT REGENCY LONDON - THE CHURCHILL
30 Portman Square
London W1H 7BH
United Kingdom

T: +44 (0)20 7486 5800
F: +44 (0)20 7486 1255
E: london.churchill@hyatt.com
hyattregencylondon.com
@HyattChurchill



FLOOR PLAN

Ground Floor

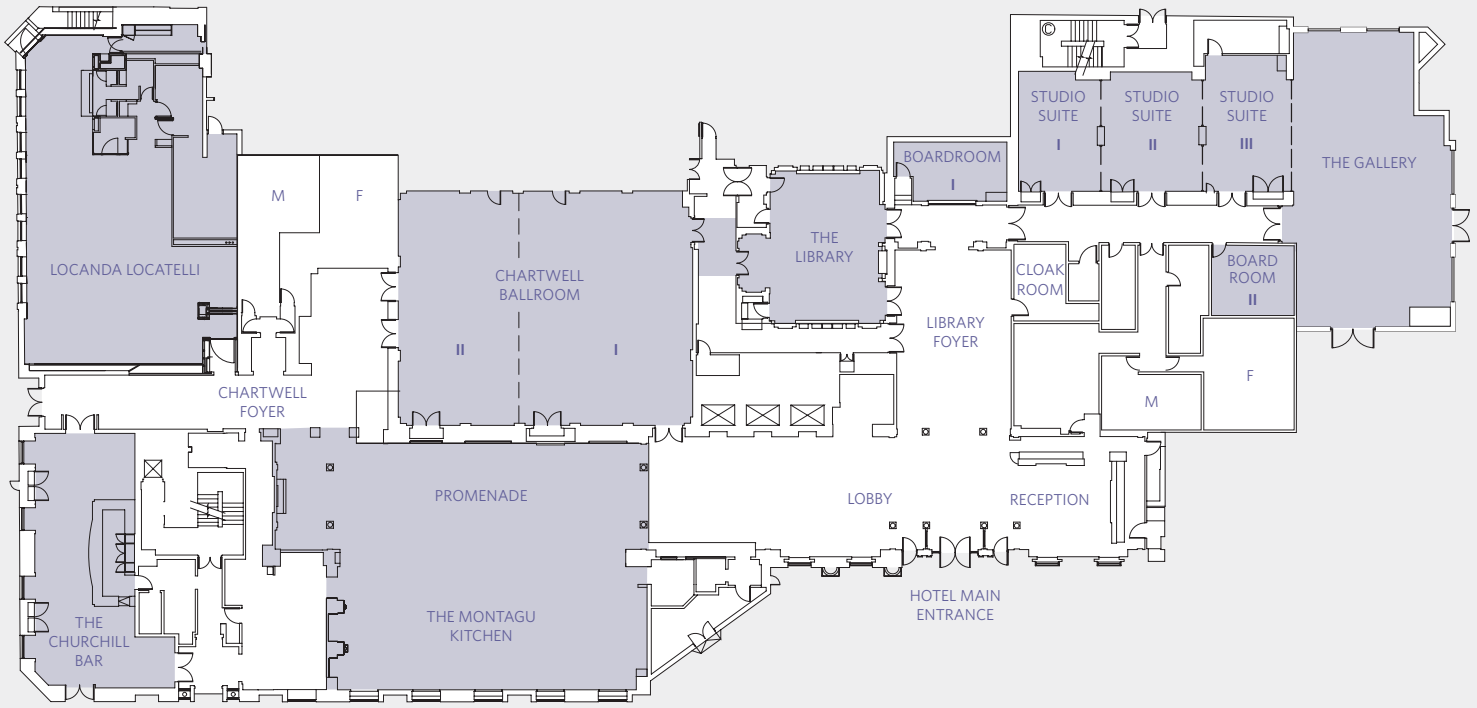

PORTMAN SQUARE GARDENS

Second Floor

