







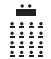

# *Sterling Hall*

Offering over 8,000 square feet of meeting and event space, including 3,300 square feet of pre-function space, Sterling Hall is a premiere venue for your next event. Located on the second floor, the space is accessed through an impressive pedestrian corridor off King Street where a private elevator and grand staircase located off the Event Lobby are available for guests. The cornerstone of Sterling Hall is the Grand Magnolia Ballroom offering 4,000 square feet of exquisite ballroom space with floor to ceiling windows overlooking King and Spring Streets. With the option to divide this ballroom into 3 separate spaces, it is ideal for wedding receptions, black-tie events, and corporate meetings.

ROOM NAME	ROOM DIMENSIONS L X W X H / METERS	SQUARE FEET METERS	 BANQUET	 CONFERENCE	 CLASSROOM	 THEATER	 U-SHAPE	 H-SQUARE	 RECEPTION
<b>GRAND MAGNOLIA BALLROOM</b>	46' x 82' 14M x 25M	4000 1219.2	250	70	275	400	70	100	500
<b>DIVISION A</b>	26' x 46' 7.9M x 14M	1326 404.2	80	36	75	125	35	40	180
<b>DIVISION B</b>	27' x 46' 8.2M x 14M	1363 415.4	80	36	75	125	35	40	180
<b>DIVISION C</b>	26' x 46' 7.9M x 14M	1312 400	80	36	75	125	35	40	180
<b>JESSAMINE ROOM</b>	15' x 31.5' 4.5M x 9.6M	596 90.2	30	26	24	48	24	30	60
<b>CAROLINA ROOM</b>	15' x 29' 4.5M x 8.8M	536 163.4	20	20	20	30	20	25	40
<b>PALMETTO ROOM</b>	15' x 18' 4.5M x 5.4M	348 106	10	16	12	25	12	16	20
<b>PALMETTO &amp; CAROLINA ROOM</b>	18' x 82' 5.4M x 25M	884 296	40	40	40	64	45	50	100



# *Sterling Hall*

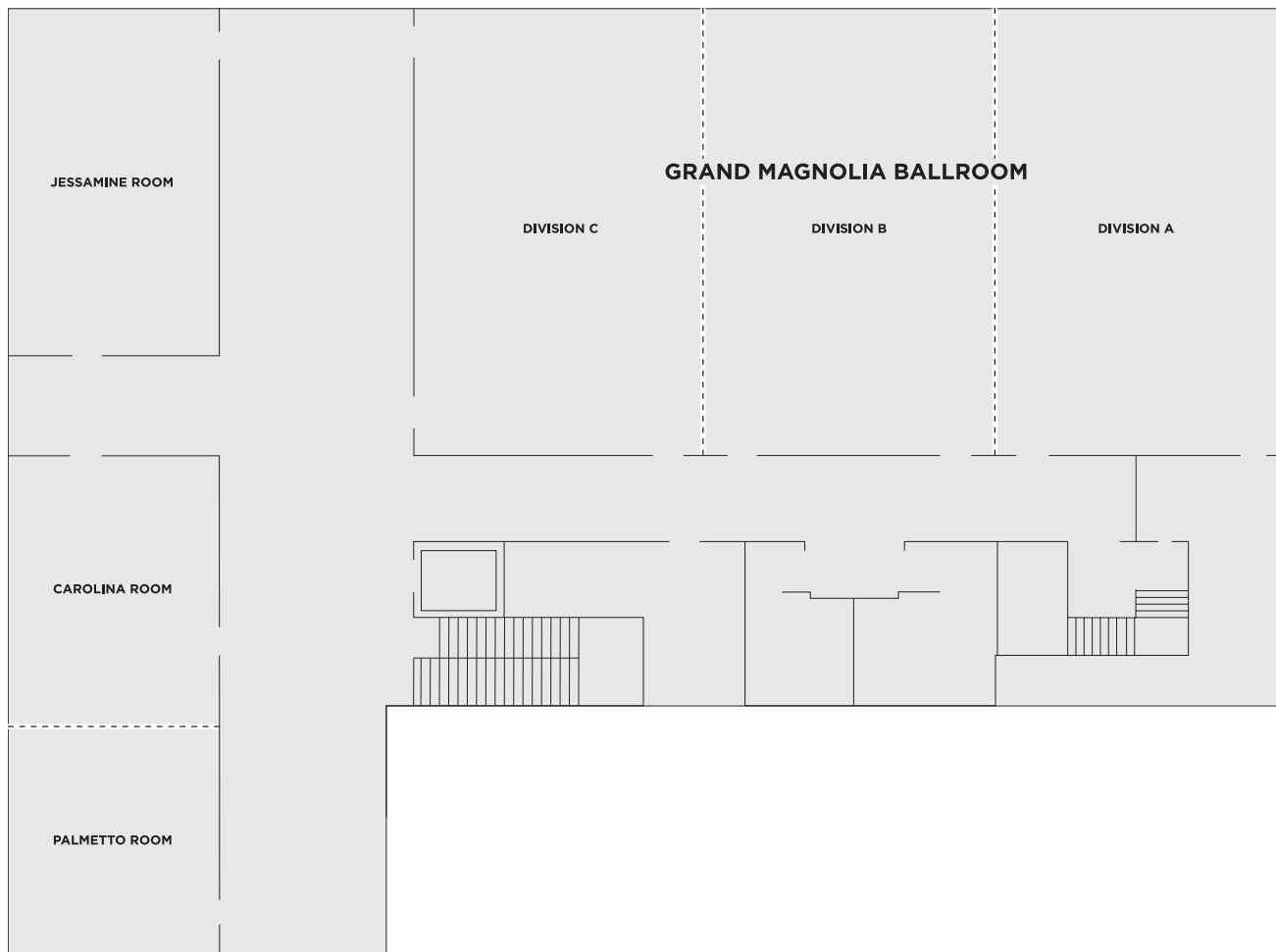

Charleston Historic District  
560 King Street, Charleston, SC 29403  
[hyatthousecharlestonhistoricdistrict.com/hyattplacecharlestonhistoricdistrict.com](http://hyatthousecharlestonhistoricdistrict.com/hyattplacecharlestonhistoricdistrict.com)