

KNOW BEFORE YOU GO

WE LOOK FORWARD TO WELCOMING YOU TO HYATT CENTRIC MONTREAL

Standing at the gateway to Old Montréal, just steps from the St. Lawrence River, Hyatt Centric Montréal is conveniently situated less than a 20-minute drive from Montréal-Pierre Elliott Trudeau International Airport (YUL). Thanks to a convenient location, you're only a 10-minute walk from downtown Montréal and a 5-minute walk from the Montréal Convention Centre.

HOTEL INFORMATION

Check-in: 4:00 pm
Check-out: 11:00 am
Minimum Age to Check In: 18
Smoke Free Property

DINING AT PUB CARTIER ARMS

Enjoy contemporary Québec-British fusion fare at our signature restaurant, Pub Cartier Arms, built near the site of the first railway station in Canada. At Hyatt Centric Montréal, you can experience locally inspired and creatively presented dining options on site, and explore the award-winning restaurants and bars dotted along the picturesque cobblestone streets of this celebrated city.

HOURS OF OPERATION

Breakfast: 7h00 to 11h00 - **Lunch:** 11h00 to 14h00 - **Diner:** 17h00 to 22h00 - **Room Service Available**

VALET PARKING INSTRUCTIONS (621 NOTRE DAME EST, H2Y 0C2)

For valet parking and hotel entrance arriving from the highway or Saint Antoine Street: Take exit 6 from QC-135, merge onto Rue St. Antoine E. Turn right, first set of traffic lights onto Rue Bonsecours and then turn left onto Rue Notre Dame East, continue for 210m and destination will be on the left.

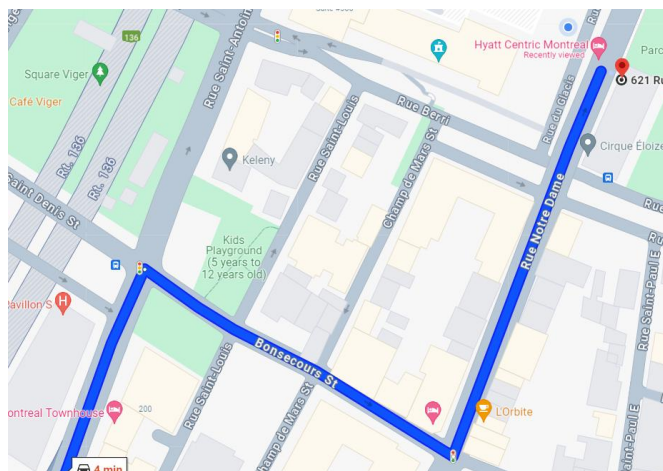

SELF PARKING INSTRUCTIONS (500 ST-HUBERT MONTREAL, H2Y 0C1)

The Garage entrance is located on Du Glacis Street, H2Y 3E5.

If arriving from Highway Take exit 6 from QC-135, merge onto Rue St. Antoine E (450m). Turn right onto Rue St-Hubert (500m). Turn right onto Rue du Glacis (29m) right before the footbridge.

From Rue St. Antoine E (350m) turn left on Rue St Hubert (160m) turn right at the 1st cross street onto 500 St Hubert/Rue du Glacis (29m) right before the footbridge.

If arriving from Hotel Main Entrance (621 Rue Notre Dame E): Head Northeast toward Rue Montcalm (600m), Turn left onto Rue Panet (110m) Turn left onto Avenue Viger E/ A. Ville-Marie/QC-136 (40M). Use the right 2 lanes to take the Ave Viger exit (220m) continue onto Avenue Viger E (350M) Turn left onto Rue St Hubert (250m) turn right onto 500 Rue St Hubert (58m).

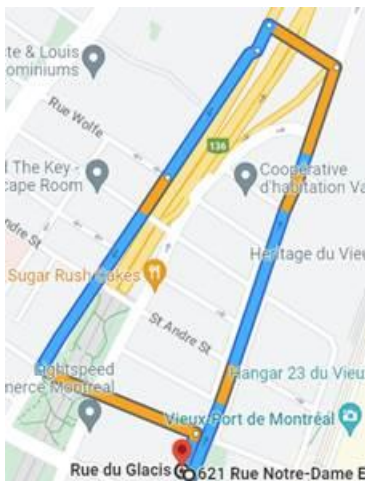

GETTING TO THE HOTEL

Montréal-Pierre Elliott Trudeau International Airport (YUL): 13 miles (21 km)

Taxi Instructions FROM AIRPORT YUL

It is possible to get a taxi at the arrivals level near the central exit located in front of the cloakroom, where a dispatcher will assist you. No reservation is required. Flat rate from airport to Downtown is CAD48.40

Mass or Public Transit:

Champ-de-Mars Metro Station: 0.4 miles (0.6 km)

Parking Instructions

Valet Parking: \$38 Pull up in front of the hotel entrance at the drop off zone (621 rue Notre E.) Kindly bring your keys to the front desk. The valet will take care of your vehicle.

On-Site Parking \$25

For self parking, garage entrance is on Du Glacis Street only accessible from 500 Rue St Hubert.

Electric Car Charging Station

Find it on the map



**HYATT
CENTRIC®**
MONTRÉAL

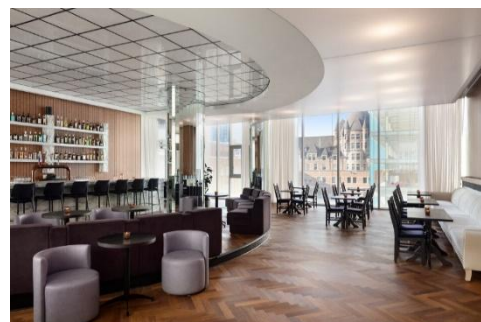

We look forward to seeing you.

www.hyattcentricmontreal.com

[Facebook](#) | [Instagram](#) | [Linkedin](#)