



Profound Change

The 46-meter long Alila Purnama consists of three decks and has been built by hand in the traditional style of a Phinisi, as used by the Bugis seafarers from South Sulawesi, Indonesia



Where Awe Meets Aah

Profound experiences transport us, reminding us how meaningful it is to be here, present and anywhere at all. Alila exists to immerse guests in rich culture and the stunning natural surroundings of the environment. This philosophy continues off-property in the local community, where Alila has earned privileged, intimate access to the rarest experiences in each destination.



ALILA PURNAMA

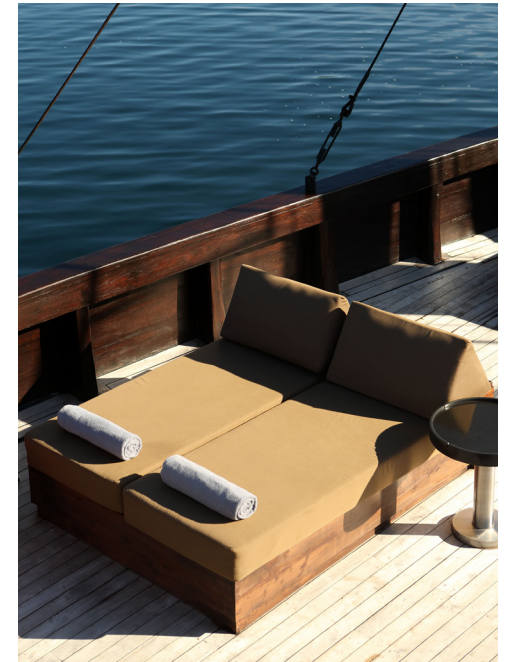

Technical Specifications

Length	46 meters
Beam	10 meters
Draught	4 meters
Engine	650hp MAN single
Speed	8 knots

Accommodation

Five well-appointed suites including one master suite are all air-conditioned with queen size beds (2 cabins can be converted to twins beds), en-suite bathrooms with shower, separate toilet, double wardrobes and writing desk.

Sriwijaya Master Suite is expansively designed with large, wraparound windows offering 180-degree views of the ever-changing landscape. Its bathroom features shower, bathtub, two washbasins and an enclosed separate toilet, while a private balcony and large sundeck with daybed and deckchairs provide the ultimate space for relaxation.



Our Rooms

1. Sriwijaya - Master Suite
2. Cirebon Suite
3. Madura Suite
4. Bali Suite
5. Jawa Suite

Facilities

A library, lounge, bar, indoor dining area seating up to 10 guests and plenty of space outside to unwind and enjoy the views. It is also equipped with complimentary WIFI access, enabling guests to upload their trip photos on a daily basis.

Guests will be able to dine at leisure in the air-conditioned dining room or the outdoor deck areas. Meals and an extensive list of non-alcoholic beverages are all-inclusive while alcoholic beverages including wines, beers, premium spirits and, cocktails are available for an additional charge.

The main outdoor deck has large oversized day beds shaded by umbrellas – perfect for relaxing day or night and enjoying the fresh sea breezes. And with a spa therapist aboard the vessel, guests can succumb to the soothing pleasures of a signature Alila massage onboard or on a nearby private beach.



TERNATE - LIBRARY



MAJAPAHIT - SALOON

Curated Experiences

Alila Purnama has a fully certified and licensed PADI dive center, catering for all levels of divers. We offer a range of courses offered onboard ranging from introductory, Open Water Diver to over 16 specialties, including Enriched Air Nitrox, Deep Dive, Peak Performance Buoyancy, Drift, Underwater Naturalist and Night Diving.

There is plenty of equipment for all guests onboard as well as a dedicated fresh water rinse tank for guests equipments. For those with a taste for adventure we offer yoga, sea kayaks, stand up paddle boards, snorkelling, inflatable toys, visiting local villages, picnic lunch or BBQ dinner by the beach are among the many other pursuits on offer.

Komodo Island



Komodo National Park is located in the centre of the Indonesian archipelago between islands of Sumbawa and Flores. The World Heritage site is blessed with secluded beaches, amazing coral reefs and crystal clear waters. The area has over 260 coral species and more than 1,000 species of reptiles, dolphins, manta rays, turtles, whales and dugongs. Komodo is considered one of the best dive sites in the world – diving or snorkelling in this area will truly leave you with extraordinary experiences.

Within the national park contains hundreds of unique species such as wild boars, water buffalos, deer's, monkeys and the famous Komodo Dragons. The Komodo Dragon is the largest land – dwelling reptile in the world with the largest found being 3.13 meters long and weighted 166KG. Their foot prints are often seen along pink sandy beaches, or while hiking in the hills with knowledgeable park rangers. They can live up to 50 years and grow over 100kg in weight and up to 3m from head to their tail tip. To raise their body temperature they bask in the sunlight during the day and burrow into the ground at night. They stalk, ambush and devour wild deer, pigs, buffalo and even horse for sustenance.

Approximately a third of the park is taken up by the up by the islands of Komodo, Rina, Gili Mota, Nusa Kode and Padar, while the rest is marine territory consisting of coral reefs, seagrass beds, mangrove, and semi – enclosed bay. The 1,817 km² Komodo National Park established in 1980 was listed by UNESCO as a World Heritage Site in 1986 and lies in the famous Coral Triangle – the global heart of the marine bio-diversity.



Diving Season
Depth of Diving
Visibility
Currents

June till September
5 - >40m
5-30m
Can be strong > 8 knot

Surface Conditions
Water Temperature
Experience Level
Number of Dive Sites

Mild to rough in some places
20 – 29 ° C
Beginner to advance
>35

ALILA JOURNEYS

Raja Ampat

Raja Ampat translated means ‘four kings’, referring to the islands Salawati, Batanta, Waigeo and Misool covering over 17,000 km² of pristine paradise. These are in turn surrounded by a myriad of amazing, untouched smaller isles with picturesque postcard beaches and sheer, ragged limestone cliffs.



The Baliem Valley, running through Irian Jaya's string of jutting mountain peaks, is home to the gentle warrior tribes of the highlands, the Dani. The region on the north-western tip of New Guinea comprises about 1,500 islands spread over 50,000 km² of spectacular scenery. It is here where the remote islands of Misool, Wayag and Penemu are located. 70% of the world's total number of coral species is said to be found in the amazing underwater world of Raja Ampat.

This area has one of the greatest and healthiest coral reefs for its size in the world with nearly 1,200 species of fish and 550 species of coral. Discover the most beautiful soft coral jungles in the world. Raja Ampat, is home to the

world's most biodiverse marine region, an underwater Shangri-la for diving enthusiasts and marine biologists. Above the water, kayak in secret bays enclosed by jagged limestone pinnacles covered with orchids and tropical vegetation.

Diving Season	November till April
Depth of Diving	5 - >40m
Visibility	10-30m
Currents	Medium to strong

Surface Conditions	Mild to strong
Water Temperature	27 - 30 ° C
Experience Level	Beginner to advance
Number of Dive Sites	>250

Cenderawasih Bay

Also known as Sarera Bay, in Papua, Indonesia, is a breathtaking destination spanning 14,535 km². It features diverse ecosystems, including mangroves, coral reefs, tropical forests, and marine habitats teeming with wildlife. History enthusiasts can explore WWII relics like sunken aircraft and ships scattered in its waters.

Your adventure begins in Manokwari aboard the luxurious Alila Purnama. Cruise to Biak to dive among WWII wrecks and trek to spot birds of paradise. At Purup Island, snorkel vibrant coral reefs and encounter reef sharks. In Kwatisore, swim with majestic whale sharks for a once-in-a-lifetime experience.

Ripon Island offers perfect visibility for diving amidst whales, dugongs, and vibrant fish. Conclude with a visit to Warirundi Island, known for its stunning coral reefs and unique marine life like coconut crabs and pygmy seahorses. End your journey with a farewell breakfast before departing from Manokwari.

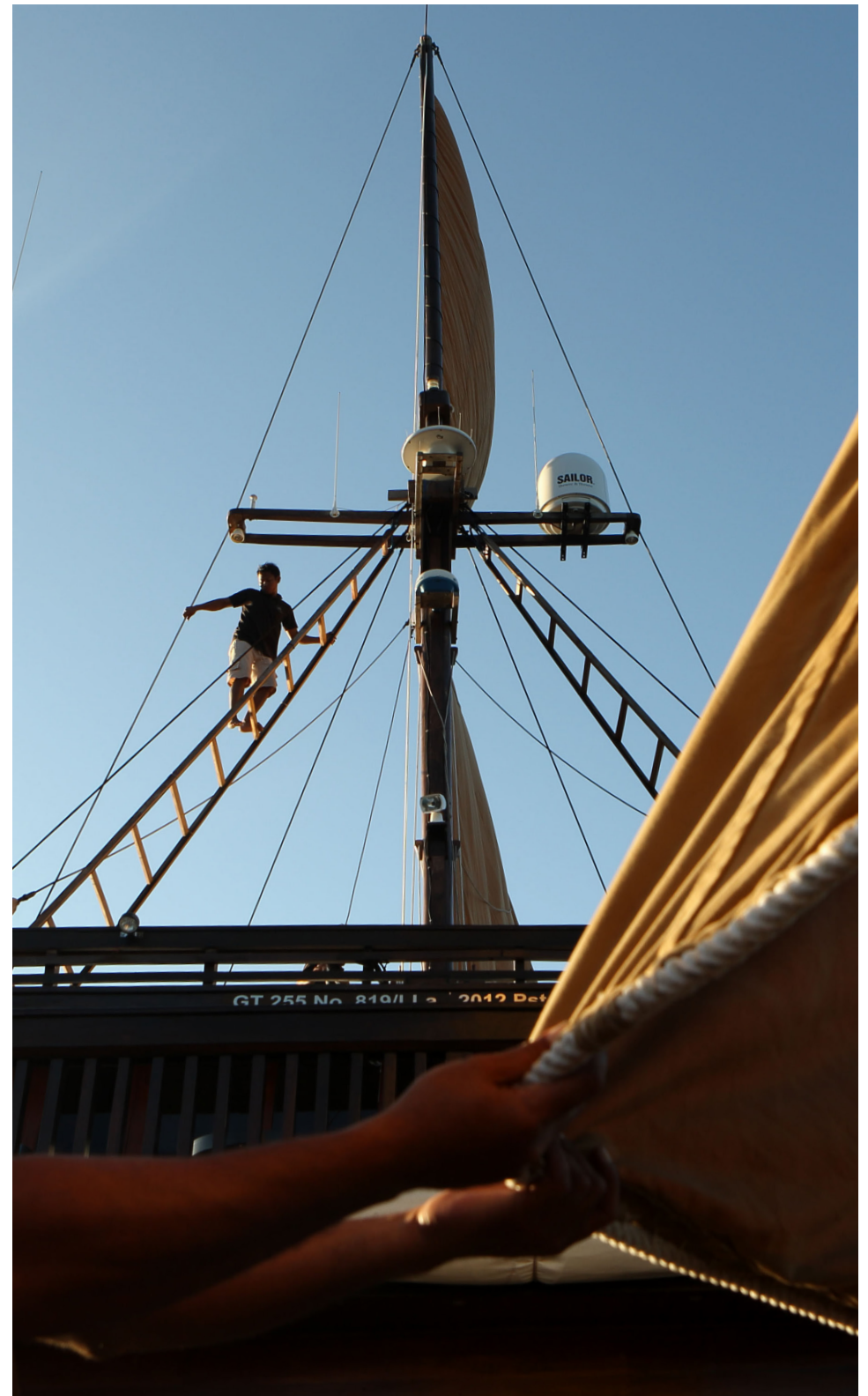



ALILA JOURNEYS

Ambon to Sorong



Embark on a 10-day cruise through the breathtaking Banda Sea and Ceram Sea, journeying from Ambon to Raja Ampat or vice versa. Discover pristine dive sites, lush islands, and diverse marine life in what has been called the last paradise on earth.

Begin at Ambon Island, known for its volcanic beauty and tropical rainforests. Dive into the waters of Nusa Laut, teeming with turtles, reef fish, and dolphins. Explore Koon Island's vibrant reefs and witness abundant fish life.

Spend two days in Misool, a diver's haven with soft corals, sea fans, and unique creatures like wobbegong sharks. Visit Banda Islands for lava flow diving and explore historic spice plantations and Fort Belgica.

In the Dampier Strait, dive among schooling fish at Sardine Reef. Conclude your journey at Raja Ampat, famed for its pristine beaches, hidden coves, and unmatched biodiversity, before bidding farewell in Sorong.

Nav Deck

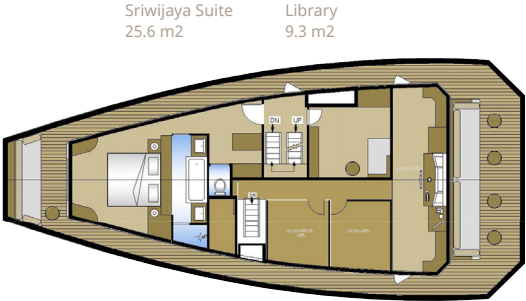

Main Deck

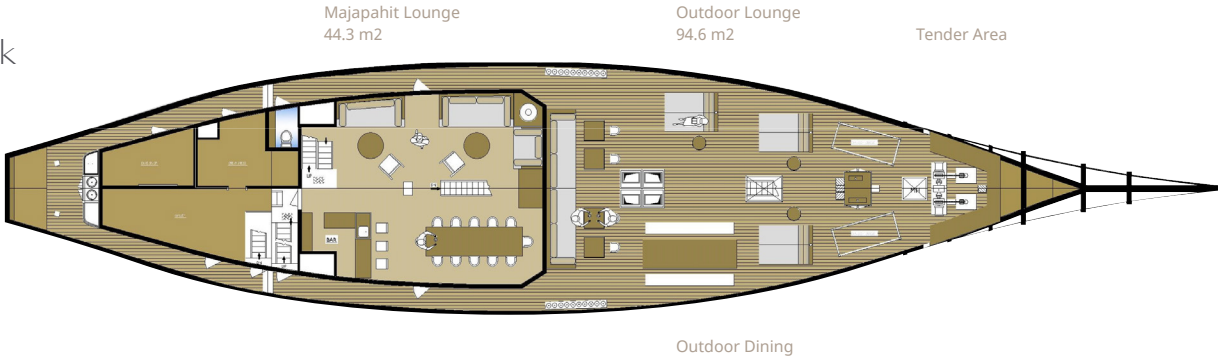

Lower Deck

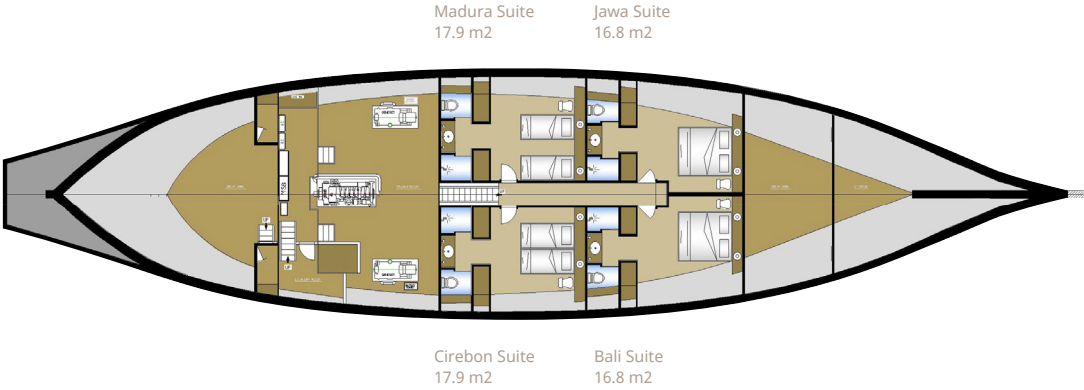

ALILA PURNAMA
Annalisa Gorelli
Cruise Director

Phone +62 821 4007 6799
Email purnama@alilahotels.com

alilahotels.com

© 2024 Hyatt Corporation. All rights reserved.